

COORDINATE POINTS

POINT	NORTH	EAST	POINT	NORTH	EAST	POINT	NORTH	EAST
S-1	8630.00	8016.00	R-2	8615.00	8000.00	RP-1	8289.80	8377.00
S-2	8700.00	8481.14	R-3	8635.40	8025.24	RP-2	8417.81	8029.86
S-3	8847.47	8797.46	R-4	8635.40	8126.24	RP-3	8441.75	8720.56
S-4	8453.65	9063.43	R-5	8635.40	8225.35	RP-4	8576.60	8566.21
S-5	8429.16	9066.50	R-6	8635.40	8326.35	RP-5	8557.32	8953.17
S-6	8862.23	8871.17	R-7	8665.45	8297.02	RP-6	8494.38	8725.24
S-7	8938.55	8898.28	R-8	8665.45	8398.02	RP-7	8789.02	8215.35
S-8	8469.44	9122.36	R-9	8679.45	8498.02	RP-8	8746.77	8786.06
S-9	8448.57	9126.37	R-10	8679.45	8599.02	RP-9	8846.50	8900.07
S-10	8885.19	8943.58	R-11	8679.45	8699.02	RP-10	8608.57	8937.08
S-11	8486.27	9185.14	R-12	8679.45	8799.02	RP-11	8372.90	8926.93
S-12	8440.86	9193.15	R-13	8679.45	8899.02	RP-12	8171.78	8999.19
S-13	8400.93	9201.16	R-14	8679.45	8999.02	RP-13	8196.29	8961.51
S-14	8327.98	9209.02	R-15	8679.45	9099.02	RP-14	7902.52	9007.10
S-15	8168.89	9232.03	R-16	8666.55	8846.13	RP-15	8176.54	9283.21
S-16	8392.50	9127.66	R-17	8469.79	9037.61	RP-16	8642.94	8884.29
S-17	8200.43	8947.69	R-18	8469.79	9138.61	RP-17	8654.67	8984.27
S-18	8138.98	8990.55	R-19	8462.19	9048.75	RP-18	8428.70	9084.50
S-19	8085.58	9152.16	R-20	8377.45	9038.23	RP-19	8153.24	9047.43
S-20	8180.41	9058.81	R-21	8249.37	8985.04	S-1	8227.75	8760.54
S-21	8102.36	9047.80	R-22	8212.39	8956.15	S-2	8606.81	8291.27
S-22	8392.06	9258.83	R-23	8192.04	8913.84	S-3	8298.26	8478.21
S-23	8377.86	9266.80	R-24	8179.51	8887.74	S-4	8449.18	8932.27
S-24	8120.39	9190.13	R-25	8081.68	8842.51	PL-1	8942.17	9012.15
S-25	8131.00	8989.03	R-26	8081.78	8922.53	PL-2	8204.89	8988.84
S-26	8026.80	8568.21	R-27	8067.03	8546.12	PL-3	8008.79	9127.75
S-27	8096.12	8942.38	R-28	7988.80	8466.80	PL-4	7787.04	9273.26
S-28	7966.18	8534.45	R-29	7881.41	8388.24	PL-5	8128.70	9187.82
S-29	8068.75	9000.74	R-30	8188.24	8893.15	PL-6	7720.88	8909.83
S-30	7803.17	8507.22	R-31	8150.22	8601.82	PL-7	7719.56	8389.83
S-31	8101.35	8545.61	R-32	8140.22	8519.14	PL-8	7884.84	8328.71
S-32	8280.52	8371.90	R-33	8042.70	8268.84	PL-9	7882.84	8328.71
S-33	8382.33	8381.38	R-34	8017.10	8131.34	PL-10	8782.47	7982.25
S-34	8301.76	8370.87	R-35	7972.64	8163.00	PL-11	8616.14	7928.44
S-35	8328.24	8354.37	R-36	7777.51	8246.78	PL-12	9041.70	7842.47
S-36	8365.61	8331.86	R-37	8431.30	8348.29	PL-13	8946.49	8667.73
S-37	8060.78	8511.50	R-38	8358.81	8186.57	PL-14	8068.81	7988.43
S-38	8360.15	8234.48	R-39	8355.38	8180.28	PL-15	8012.81	7881.12
S-39	7981.99	8482.52	R-40	8352.32	8184.27	PL-16	8949.70	7986.44
S-40	8337.03	8214.07	R-41	8327.47	8182.14	PL-17	8802.22	7892.31
S-41	8543.57	8330.54	R-42	8272.27	8024.56	PL-18	7908.98	8061.14
S-42	8608.47	8299.35	R-43	8243.85	8034.28	PL-19	8564.25	8389.84
S-43	8687.88	8285.89	R-44	8223.81	8020.20	PL-20	7769.83	8389.74
S-44	8781.85	8438.02	R-45	8491.88	8002.37	PL-21	7728.68	8414.79
R-1	8589.45	8014.58	R-46	8474.47	8015.86	PL-22	7740.58	8046.95
			R-47	8451.25	8001.81			

CURVE DATA

CURVE	RP	RADIUS	LENGTH	ANGLE	CURVE	RP	RADIUS	LENGTH	ANGLE
S-3 TO S-4	1	710.00	480.18	38°49'00"	S-31 TO S-32	5	450.00	247.80	28°46'00"
S-4 TO S-5	2	138.49	14.82	0°07'33"	S-32 TO S-33	5	448.00	22.60	2°18'31"
S-5 TO S-6	1	710.00	473.86	38°15'00"	S-33 TO S-34	5	448.00	68.00	6°09'33"
S-6 TO S-7	2	199.49	21.35	0°07'33"	S-34 TO S-35	5	448.00	68.00	6°09'33"
S-7 TO S-8	1	836.00	472.84	32°23'33"	S-35 TO S-36	5	448.00	445.17	31°28'33"
S-8 TO S-9	1	268.48	48.16	10°15'00"	S-36 TO S-37	6	161.02	78.20	29°40'12"
S-9 TO S-10	3	249.00	178.84	31°00'00"	S-37 TO S-38	6	161.02	68.16	29°40'12"
S-10 TO S-11	1	836.00	472.84	32°23'33"	S-38 TO S-39	6	161.02	78.20	29°40'12"
S-11 TO S-12	1	836.00	472.84	32°23'33"	S-39 TO S-40	6	161.02	78.20	29°40'12"
S-12 TO S-13	1	836.00	472.84	32°23'33"	S-40 TO S-41	6	161.02	78.20	29°40'12"
S-13 TO S-14	3	249.00	178.84	31°00'00"	S-41 TO S-42	6	161.02	78.20	29°40'12"
S-14 TO S-15	1	836.00	472.84	32°23'33"	S-42 TO S-43	6	161.02	78.20	29°40'12"
S-15 TO S-16	1	836.00	472.84	32°23'33"	S-43 TO S-44	6	161.02	78.20	29°40'12"
S-16 TO S-17	1	836.00	472.84	32°23'33"	S-44 TO S-45	6	161.02	78.20	29°40'12"
S-17 TO S-18	1	836.00	472.84	32°23'33"	S-45 TO S-46	6	161.02	78.20	29°40'12"
S-18 TO S-19	1	836.00	472.84	32°23'33"	S-46 TO S-47	6	161.02	78.20	29°40'12"
S-19 TO S-20	3	249.00	178.84	31°00'00"	S-47 TO S-48	6	161.02	78.20	29°40'12"
S-20 TO S-21	1	836.00	472.84	32°23'33"	S-48 TO S-49	6	161.02	78.20	29°40'12"
S-21 TO S-22	1	836.00	472.84	32°23'33"	S-49 TO S-50	6	161.02	78.20	29°40'12"
S-22 TO S-23	1	836.00	472.84	32°23'33"	S-50 TO S-51	6	161.02	78.20	29°40'12"
S-23 TO S-24	3	249.00	178.84	31°00'00"	S-51 TO S-52	6	161.02	78.20	29°40'12"
S-24 TO S-25	1	836.00	472.84	32°23'33"	S-52 TO S-53	6	161.02	78.20	29°40'12"
S-25 TO S-26	1	836.00	472.84	32°23'33"	S-53 TO S-54	6	161.02	78.20	29°40'12"
S-26 TO S-27	1	836.00	472.84	32°23'33"	S-54 TO S-55	6	161.02	78.20	29°40'12"
S-27 TO S-28	1	836.00	472.84	32°23'33"	S-55 TO S-56	6	161.02	78.20	29°40'12"
S-28 TO S-29	1	836.00	472.84	32°23'33"	S-56 TO S-57	6	161.02	78.20	29°40'12"
S-29 TO S-30	4	678.00	531.00	45°00'22"	S-57 TO S-58	6	161.02	78.20	29°40'12"
					S-58 TO S-59	6	161.02	78.20	29°40'12"
					S-59 TO S-60	6	161.02	78.20	29°40'12"

- NOTES:**
- ALL DIMENSIONS THIS SHEET ARE TO BUILDING COLUMN LINE, FACE OF CURB OR CENTERLINE, EXCEPT AS SHOWN.
 - COMPACT PARKING AREA-SEE DETAIL.
 - HANDICAP PARKING AREA-SEE DETAIL.
 - STANDARD PARKING AREA-SEE DETAIL.
 - STANDARD PARKING WITH CURBING - SEE DETAIL.
 - STANDARD PARKING WITH WHEEL STOPS - SEE DETAIL.
 - SEE SHEET C4 FOR STANDARD LEGEND.

ABBREVIATIONS

S	PARKING SURFACE POINT	B	BUILDING COLUMN LINE
R	ROAD SURFACE POINT	I	INTERSECTION POINT
RP	RADIUS POINT	PL	PROPERTY LINE POINT

REVISED AS PER AMENDMENT NO 1
 REVISED AS PER ADDENDUM NO 1

SITE LAYOUT PLAN

NORTHERN CALIFORNIA REGIONAL OFFICE
 ROHNERT PARK, CALIFORNIA

STATE FARM MUTUAL AUTOMOBILE
 INSURANCE COMPANY
 BLOOMINGTON, ILLINOIS

R.O. 39-1

WILLIAM R. SHANNON, JR., A.I.A.
 ONE APPLETREE SQUARE
 BLOOMINGTON, MINNESOTA 55420

DATE 5-20-76
 IN CHARGE JDB
 DRAWN BY RWQ
 CHECKED BY LWQ
 COMM. NO. 5821-6220
 SHEET NO. C1



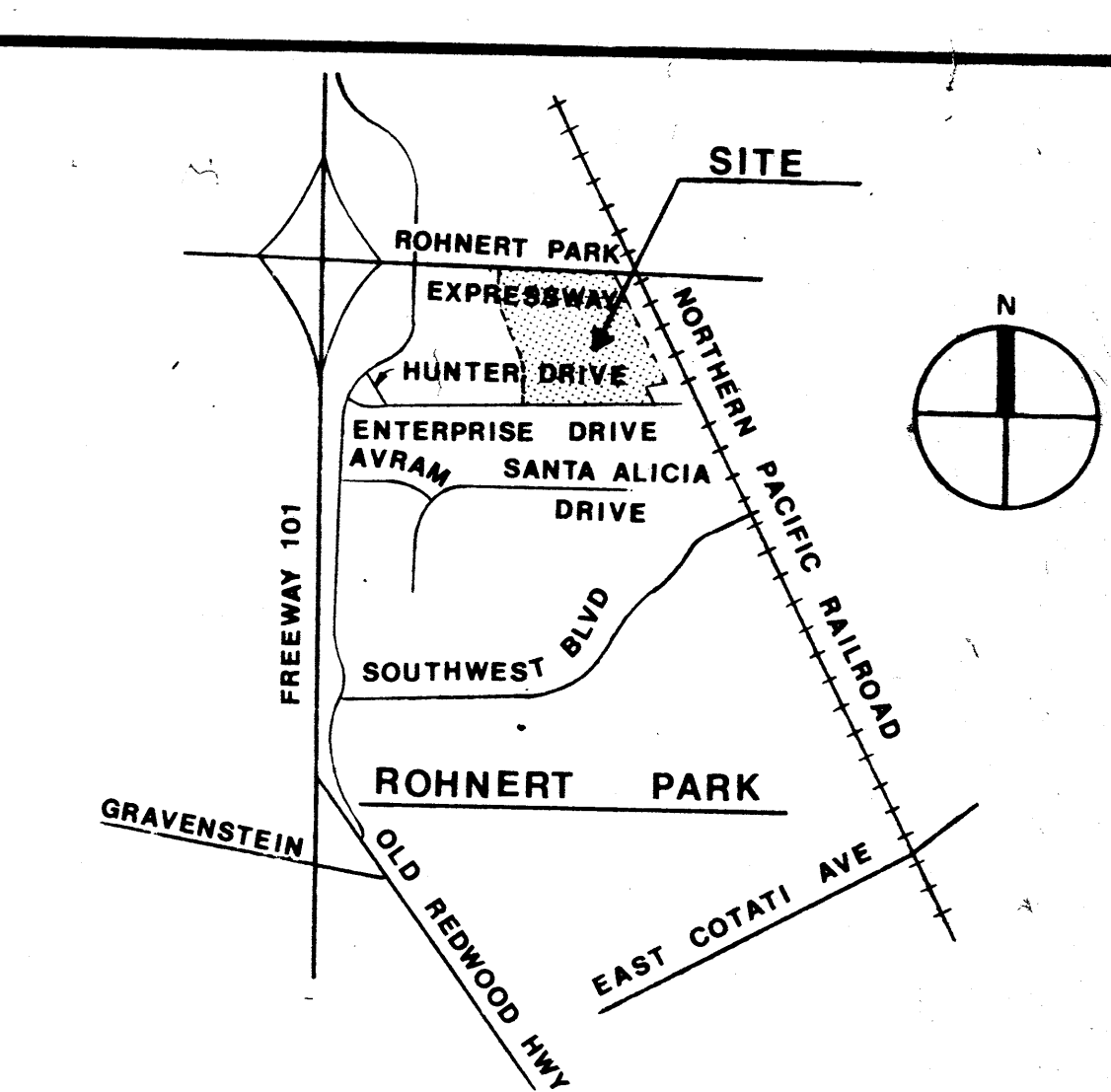
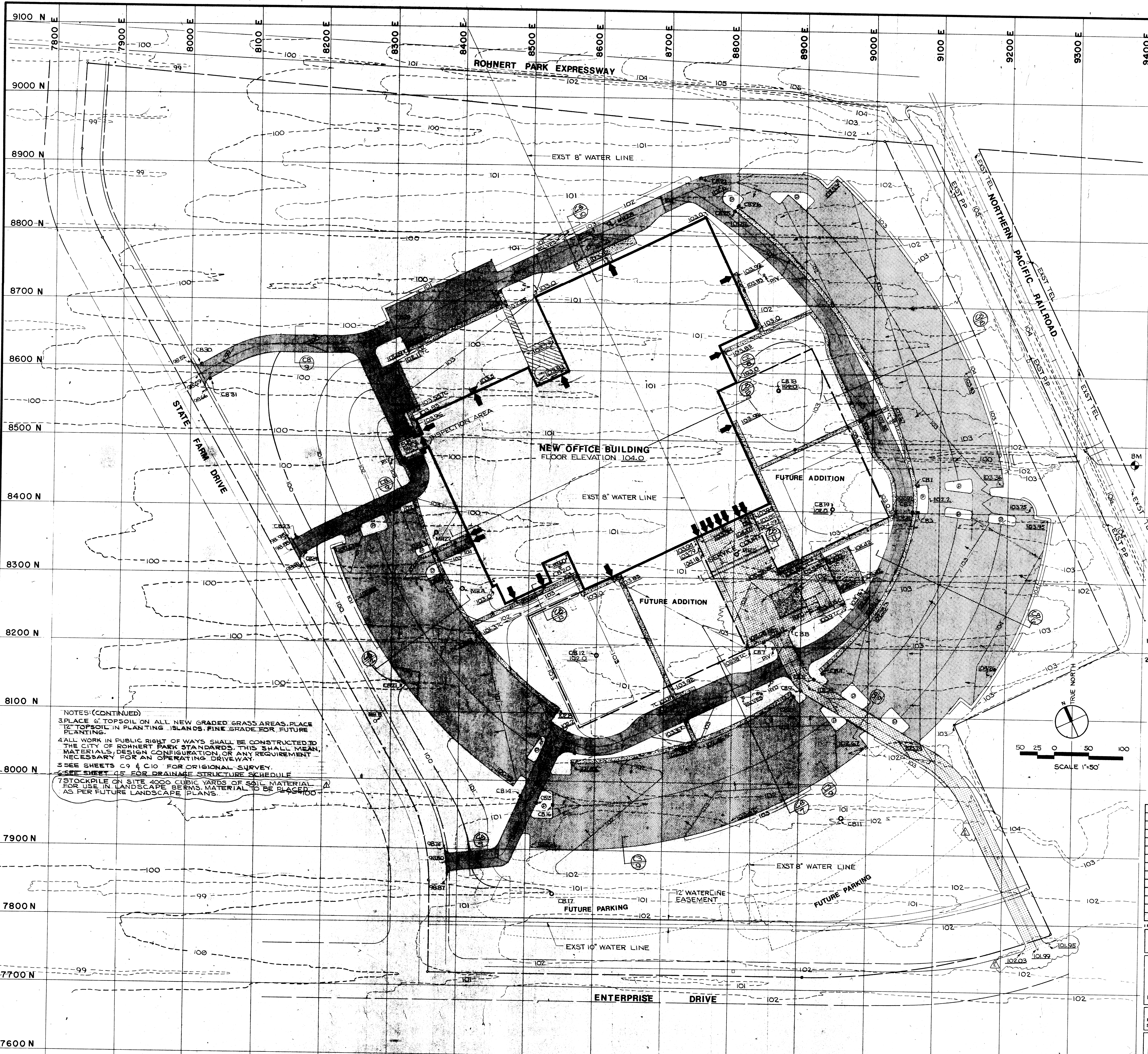

VICINITY MAP
NOT TO SCALE

STANDARD LEGEND - GENERAL CONSTRUCTION

EXISTING	NEW	DESCRIPTION
---	---	PROPERTY LINE
---	---	EASEMENT LINE
---	---	CONSTRUCTION LIMIT
---	---	CONTOUR
---	---	SPOT ELEVATION
---	---	BUILDING
---	---	UNDERGROUND STRUCTURE
---	---	RAILROAD
---	---	CULVERT & END SECTION
---	---	EXPOSED AGGREGATE FINISH
---	---	CONCRETE
---	---	SLOPE DIRECTION
---	---	FENCE
---	---	GUARD RAIL
---	---	TREE-SAVE
---	---	TREE-REMOVE
---	---	DOORWAY
---	---	BENCHMARK LOCATION
---	---	DETAIL REFERENCE
---	---	TRUCK DRIVE & SERVICE COURT AREA
---	---	AUTOMOBILE & LIGHT TRUCK DRIVE
---	---	AUTOMOBILE PARKING
---	---	PLANTING ISLAND
---	---	NUMBER OF CAR STALLS

NOTE:
ITEMS SHOWN ON THIS STANDARD LEGEND MAY NOT APPLY TO THIS PROJECT

- NOTES:
1. BENCHMARK - CHISELED SQUARE IN RAILROAD HEADWALL ON EAST SIDE OF PROPERTY - ELEVATION 104.97
2. ASPHALTIC CONCRETE PAVEMENT SHALL CONFORM TO THE FOLLOWING SECTIONS:

AREA	ASPHALT CONCRETE SURFACING	CLASS 2 AGGREGATE BASE	CLASS 4 AGGREGATE OR LIME-TREATED SUBBASE
TRUCK DRIVEWAY AND SERVICE AREA	2.5"	14.5"	
ALTERNATE	2.5"	7.5"	8.0"
AUTOMOBILE AND LIGHT TRUCK DRIVES	1.5"	11.5"	
ALTERNATE	1.5"	6.0"	6.0"
AUTOMOBILE PARKING	1.5"	8.5"	
ALTERNATE	1.5"	5.0"	4.0"

SEE NOTES CONTINUED @ LEFT

NOTES (CONTINUED)
3. PLACE 6" TOPSOIL ON ALL NEW GRADED GRASS AREAS. PLACE 12" TOPSOIL IN PLANTING ISLANDS. FINE GRADE FOR FUTURE PLANTING.
4. ALL WORK IN PUBLIC RIGHT OF WAYS SHALL BE CONSTRUCTED TO THE CITY OF ROHNERT PARK STANDARDS. THIS SHALL MEAN MATERIALS, DESIGN CONFIGURATION, OR ANY REQUIREMENT NECESSARY FOR AN OPERATING DRIVEWAY.
5. SEE SHEETS C9 & C10 FOR ORIGINAL SURVEY.
6. SEE SHEET C5 FOR DRAINAGE STRUCTURE SCHEDULE.
7. STOCKPILE ON SITE 4000 CUBIC YARDS OF SOIL MATERIAL FOR USE IN LANDSCAPE BERMS. MATERIAL TO BE PLACED AS PER FUTURE LANDSCAPE PLANS.

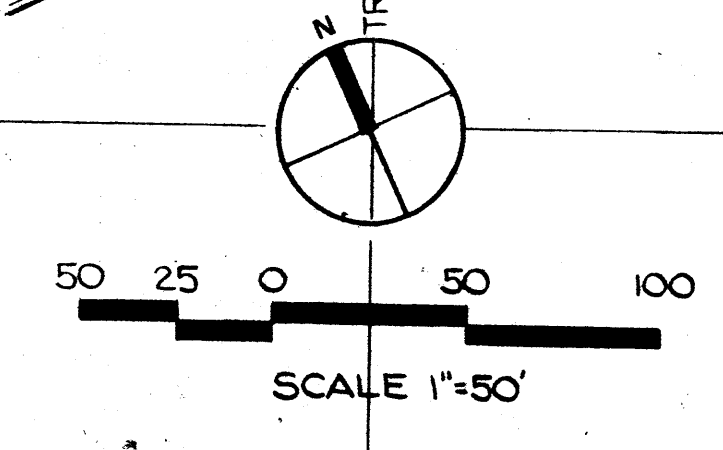

REVISED PER AMMENDMENT NO 1 8-12-76
REVISED PER ADDENDUM NO 1 6-01-76

SITE GRADING PLAN

NORTHERN CALIFORNIA REGIONAL OFFICE
ROHNERT PARK, CALIFORNIA

STATE FARM MUTUAL AUTOMOBILE
INSURANCE COMPANY
BLOOMINGTON, ILLINOIS

R.O. 39-1

WILLIAM R. SHANNON, JR., A.I.A.
REGISTRATION NO. C483 ONE APPLE TREE SQUARE
STATE OF CALIFORNIA BLOOMINGTON, MINNESOTA 55420

DATE: 5-20-76
IN CHARGE: J.D.S.
DRAWN BY: RWQ
CHECKED BY: L.W.E.
COMM. NO.: 5521422D
SHEET NO.: **C4**



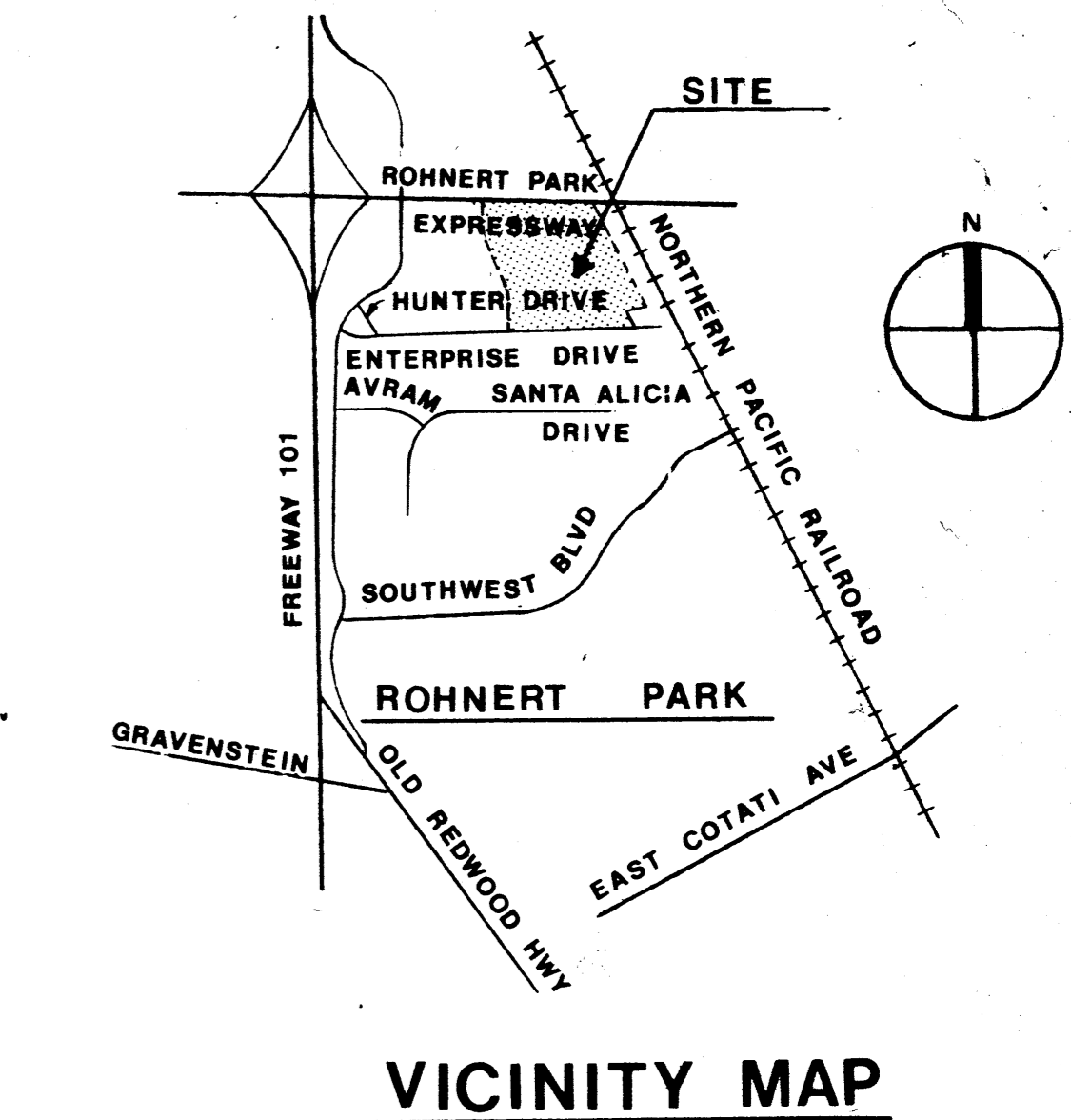
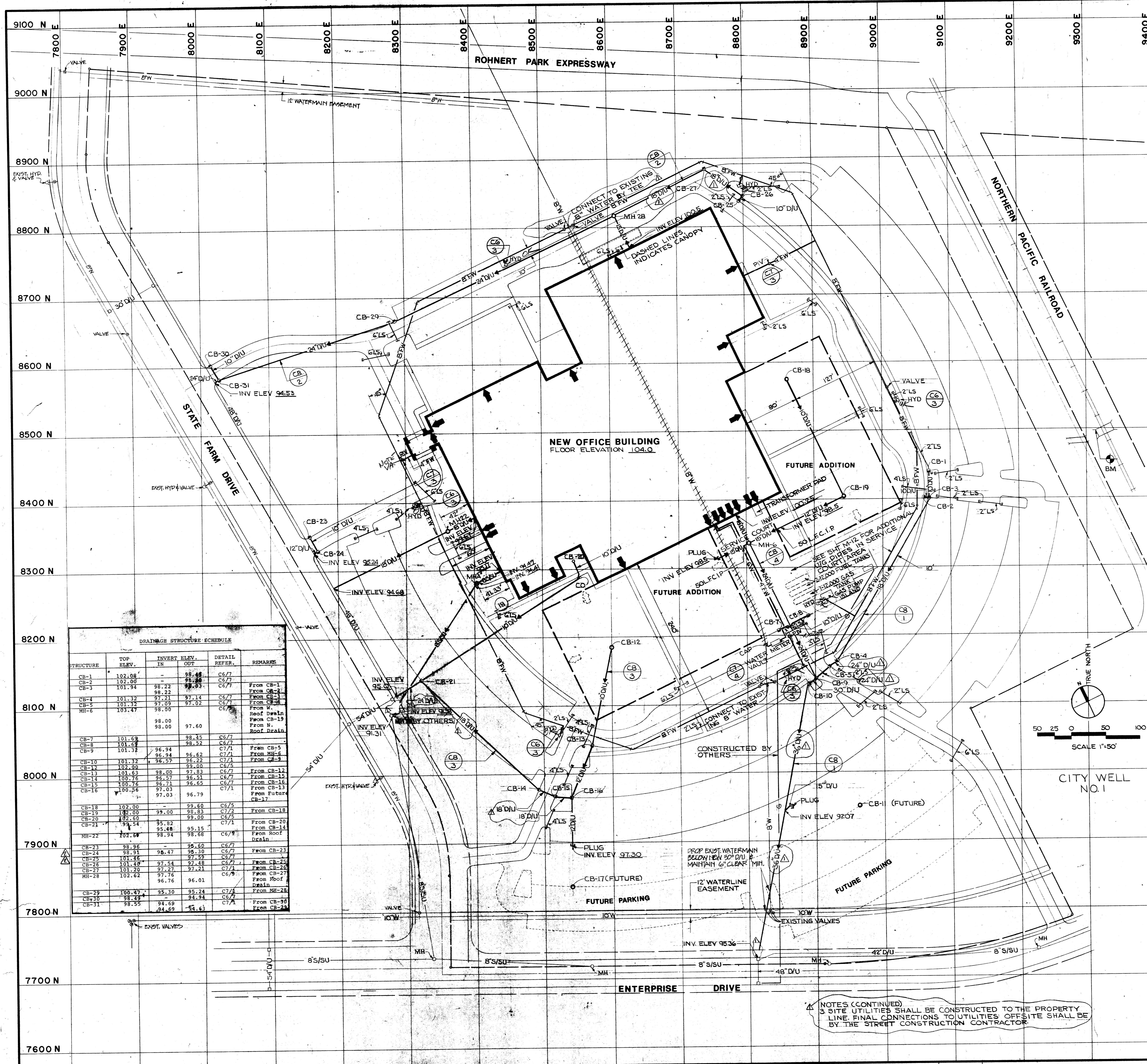

STANDARD LEGEND—MECHANICAL CONSTRUCTION

EXISTING	NEW	DESCRIPTION
—	—	PROPERTY LINE
—	—	EASEMENT LINE
—	—	CONSTRUCTION LIMIT
MH	MH	STORM SEWER—UNDERGROUND
○	○	SANITARY SEWER—UNDERGROUND
○	○	COMBINED SEWER
○	○	FORCE MAIN
○	○	WATER LINE
○	○	POST INDICATOR VALVE
○	○	FIRE LINE
○	○	GAS LINE
○	○	OXYGEN LINE
○	○	FUEL OIL SUPPLY
○	○	FUEL OIL RETURN
○	○	GASOLINE LINE
○	○	ELECTRIC—OVERHEAD
○	○	ELECTRIC—UNDERGROUND
○	○	TELEPHONE—OVERHEAD
○	○	TELEPHONE—UNDERGROUND
○	○	SUBDRAIN
○	○	LAWNSPRINKLER LINE
○	○	STEAM & RETURN LINE
○	○	DETAIL REFERENCE

REMOVALS

DESCRIPTION
 UTILITY TYPE AS NOTED

NOTE:
 ITEMS SHOWN ON THIS LEGEND MAY NOT APPLY TO THIS PROJECT.

NOTES:
 1. SEE DETAIL C2/7 FOR DETAIL OF SERVICE COURT AREA.
 2. LANSPRINKLING PIPING
 PIPING SHALL BE INSTALLED UNDER ROADS, PARKING AND WALK AREAS AS SHOWN ON THE DRAWINGS. PIPING SHALL EXTEND A MINIMUM OF TWO FEET INTO THE PLANTING AND LAWN AREAS FOR FUTURE CONNECTION TO THE LANSPRINKLING SYSTEM.
 PIPES SHALL BE PLASTIC (PVC), CLASS 160. JOINTS SHALL BE PLAIN END SOLVENT WELD TYPE. PLASTIC PIPE FITTINGS AND/OR CONNECTORS SHALL BE MOLDED FITTINGS OF THE SAME MATERIAL AS THE PIPE SUITABLE FOR SOLVENT WELD. P.V.C. SCHEDULE 40 SHALL BE USED.
 SOLVENT WELD CEMENT SPECIFICALLY FORMULATED TO SOLVENT WELD PLASTIC PIPE AND FITTINGS SHALL BE USED. CABOT TYPE 40R OR APPROVED EQUAL.
 PIPE SHALL BE LAID WITH A MINIMUM COVER OF 24 INCHES FROM FINAL GRADE.
 CAP ALL ENDS SECURELY AND STAKE END LOCATIONS FOR FUTURE USE.
 ALL PIPE SECTIONS TO BE USED FOR WATER SERVICE SHALL BE PRESSURE TESTED AT 100 P.S.I. PRESSURE TO INSURE LEAK TIGHT CONNECTIONS. ALL LEAKS SHALL BE REPAIRED AND RETESTED UNTIL THE SYSTEM IS FOUND LEAK PROOF. THE CONTRACTOR SHALL VERIFY WITH THE LANDSCAPE ARCHITECT TO DETERMINE WHICH PIPES NEED PRESSURE TESTING.

DRAINAGE STRUCTURE SCHEDULE

STRUCTURE	TOP ELEV.	INVERT ELEV. IN	INVERT ELEV. OUT	DETAIL REFER.	REMARKS
CB-1	102.08	-	98.48	C6/7	
CB-2	102.00	98.22	98.22	C6/7	From CB-1
CB-3	101.94	98.22	98.22	C6/7	From CB-2
CB-4	101.32	97.21	97.14	C6/7	From CB-3
CB-5	101.32	97.09	97.02	C6/7	From CB-4
MH-6	101.47	98.00	98.00	C6/7	From Roof Drain
		98.00	97.60		From N. Roof Drain
CB-7	101.69	98.45	98.45	C6/7	
CB-8	101.32	96.94	96.62	C7/1	From CB-5
CB-9	101.32	96.94	96.62	C7/1	From MH-6
CB-10	101.32	96.57	96.22	C6/5	From CB-9
CB-11	102.00	98.00	98.00	C6/5	From CB-12
CB-12	101.63	98.00	97.93	C6/7	From CB-13
CB-13	100.76	96.57	96.51	C6/7	From CB-14
CB-14	100.76	96.71	96.65	C6/7	From CB-15
CB-15	100.56	97.03	96.79	C7/1	From CB-16
CB-16	100.56	97.03	96.79	C7/1	From CB-17
CB-17	100.56	97.03	96.79	C7/1	From Future
CB-18	102.00	99.00	99.60	C6/5	From CB-18
CB-19	102.00	99.00	99.00	C6/5	From CB-20
CB-20	102.00	99.00	99.00	C6/5	From CB-19
CB-21	102.00	99.54	99.15	C7/1	From CB-20
MH-22	102.68	98.94	98.68	C6/9	From Roof Drain
CB-23	98.36	95.60	95.60	C6/7	From CB-23
CB-24	98.31	95.47	95.30	C6/7	From CB-25
CB-25	101.46	97.59	97.59	C6/7	From CB-26
CB-26	101.40	97.54	97.48	C6/7	From CB-27
CB-27	101.20	97.27	97.21	C7/1	From CB-28
MH-28	102.62	97.76	96.01	C6/9	From Roof Drain
CB-29	100.47	95.30	95.24	C7/1	From MH-28
CB-30	98.49	94.69	94.34	C6/7	From CB-30
CB-31	98.55	94.69	94.63	C7/1	From CB-30

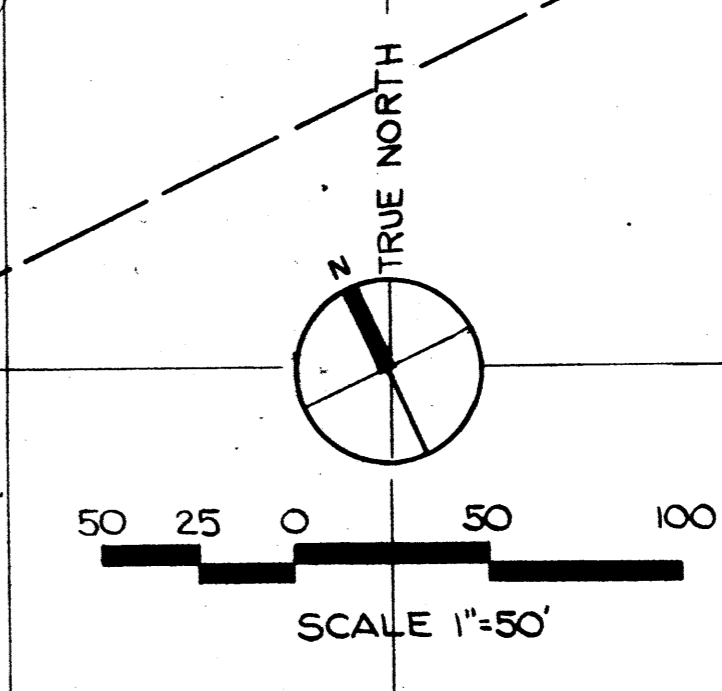

NOTES (CONTINUED)
 3. SITE UTILITIES SHALL BE CONSTRUCTED TO THE PROPERTY LINE. FINAL CONNECTIONS TO UTILITIES OFFSITE SHALL BE BY THE STREET CONSTRUCTION CONTRACTOR.

REVISED AS PER AMENDMENT NO. 1 8/27/6
 REVISED AS PER ADDENDUM NO. 1 6-21-76

SITE UTILITY PLAN

NORTHERN CALIFORNIA REGIONAL OFFICE
 ROHNERT PARK, CALIFORNIA

STATE FARM MUTUAL AUTOMOBILE
 INSURANCE COMPANY
 BLOOMINGTON, ILLINOIS

R.O. 39-1

WILLIAM R. SHANNON, JR., A.S.A.
 REGISTRATION NO. 0485
 STATE OF CALIFORNIA BLOOMINGTON, MINNESOTA 55420

DATE 5-20-76
 IN CHARGE JDB
 DRAWN BY RWO
 CHECKED BY LWE
 COMM. NO. 5621-6220

SHEET NO
C5

Ellerbe

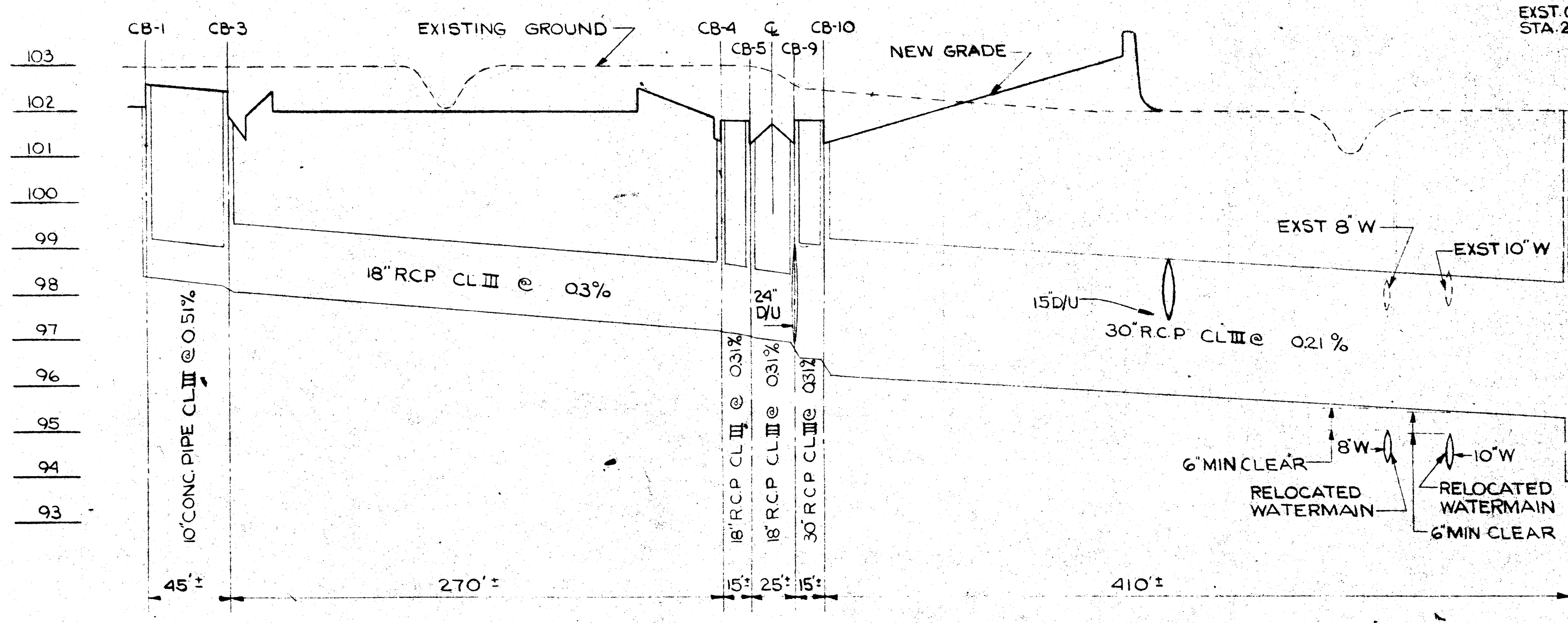

NOTE: VERIFY ALL DISTANCES BETWEEN STRUCTURES IN FIELD

CB 1 STORM SEWER PROFILE
SCALE: HORIZ. 1"=50'
VERT. 1"=2'

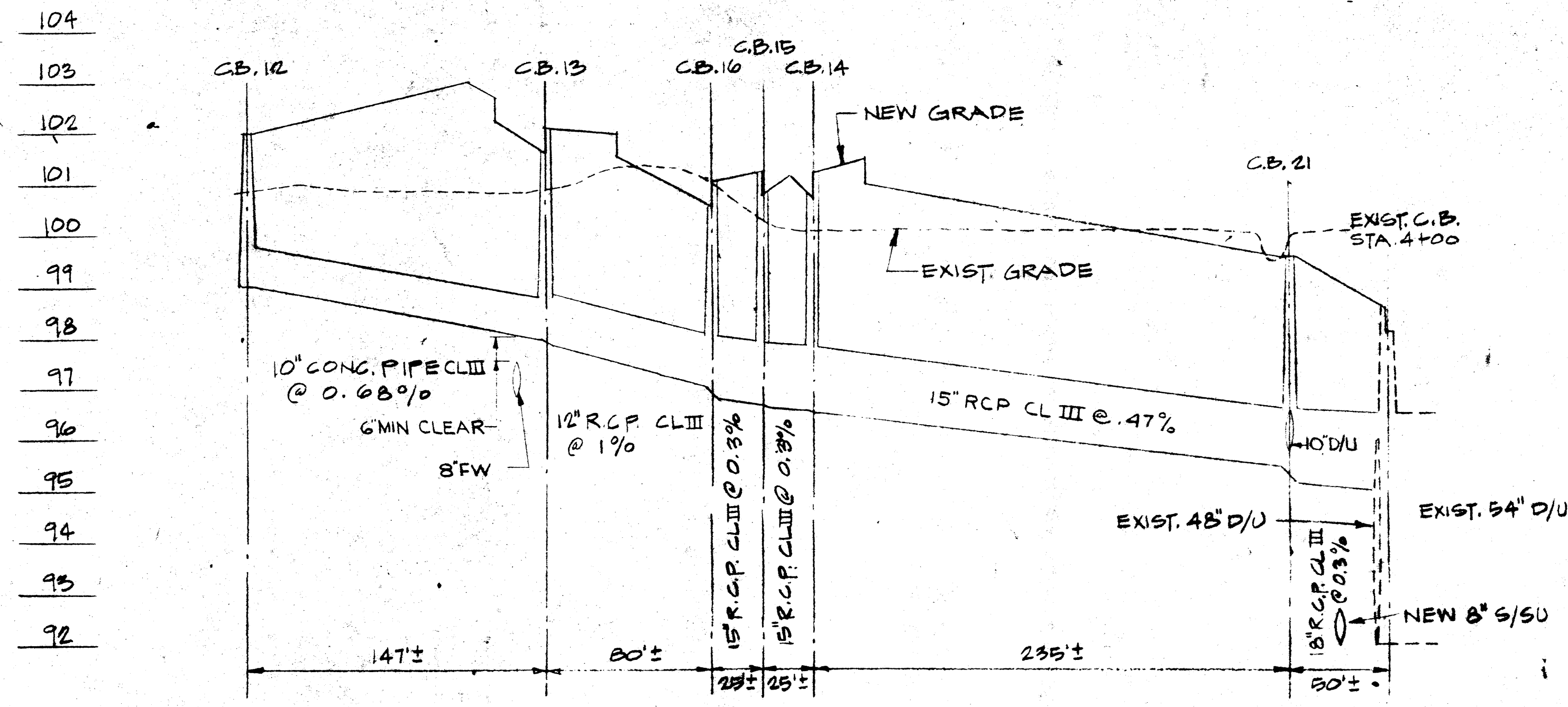

NOTE: VERIFY ALL DISTANCES BETWEEN STRUCTURES IN FIELD

CB 3 STORM SEWER PROFILE
SCALE: HORIZ. 1"=50'
VERT. 1"=2'

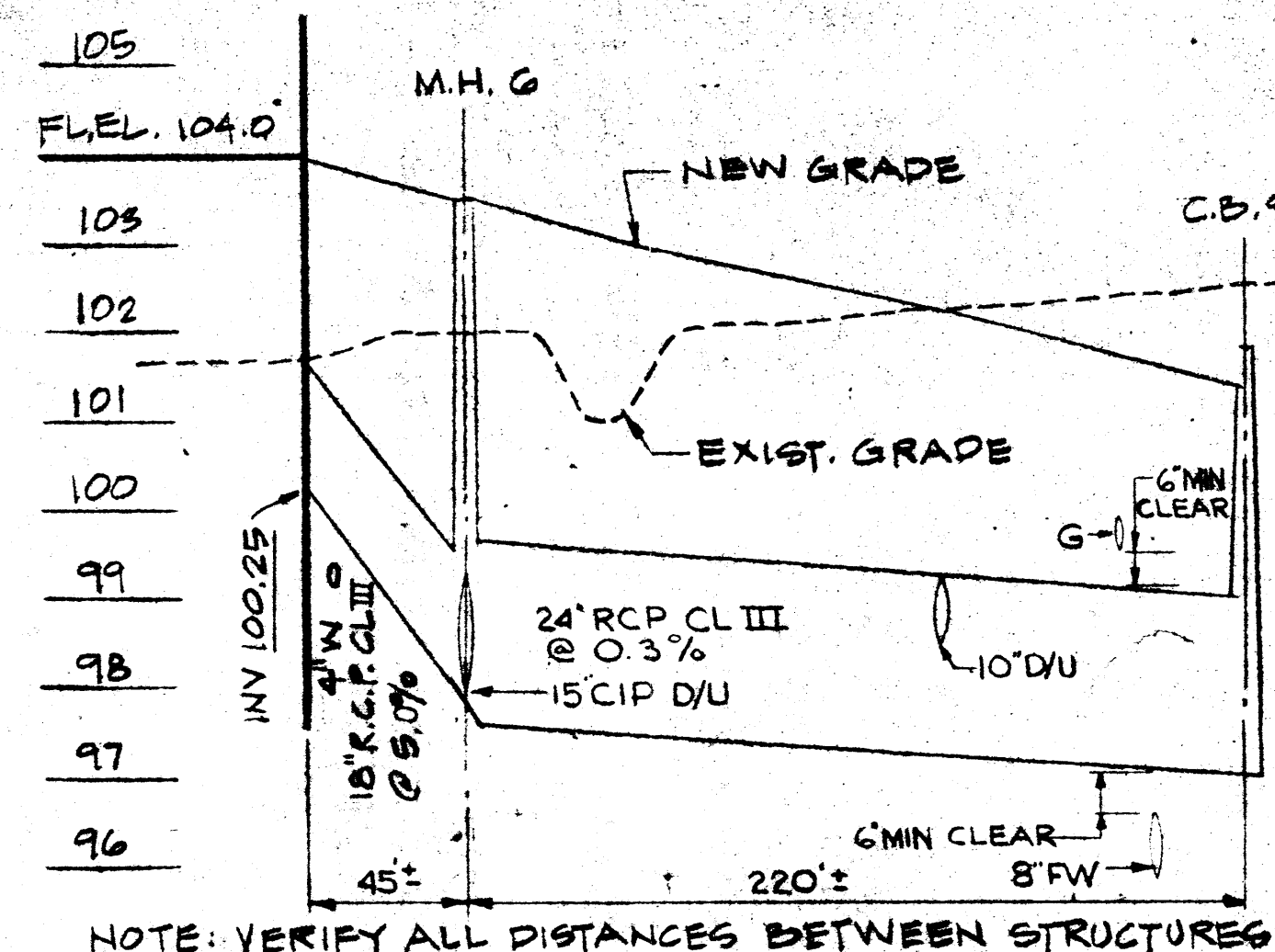

NOTE: VERIFY ALL DISTANCES BETWEEN STRUCTURES IN FIELD

CB 4 STORM SEWER PROFILE
SCALE: HORIZ. 1"=50'
VERT. 1"=2'

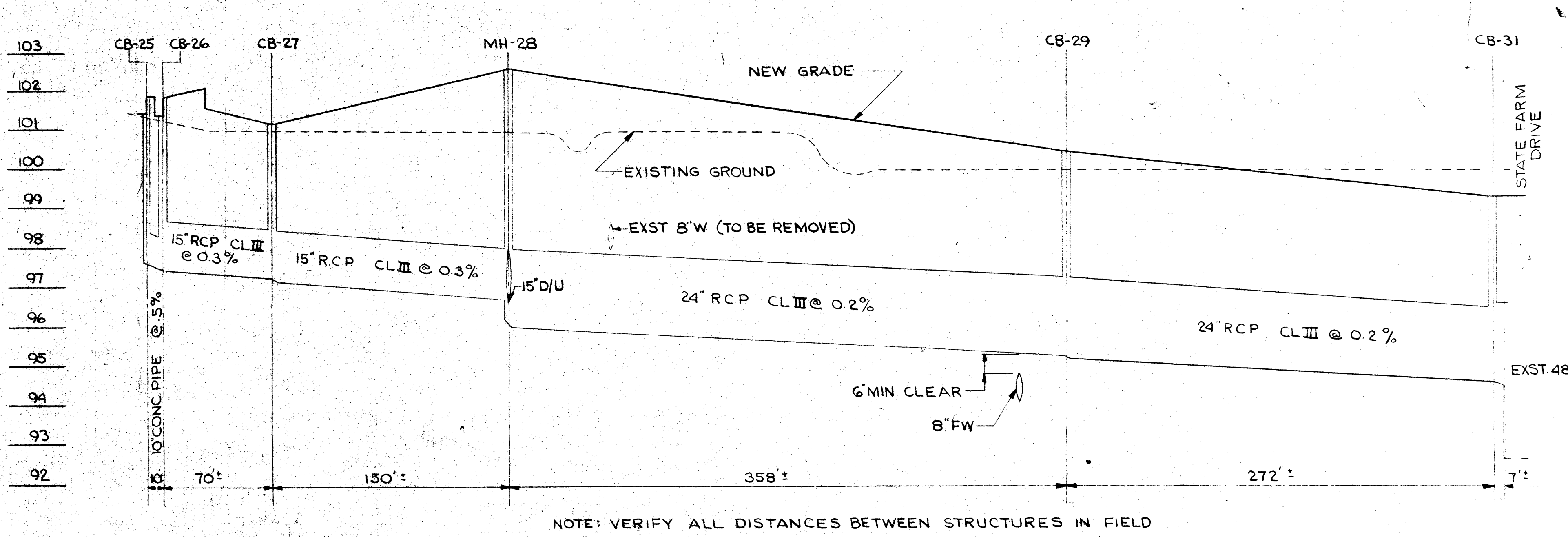

NOTE: VERIFY ALL DISTANCES BETWEEN STRUCTURES IN FIELD

CB 2 STORM SEWER PROFILE
SCALE: HORIZ. 1"=50'
VERT. 1"=2'

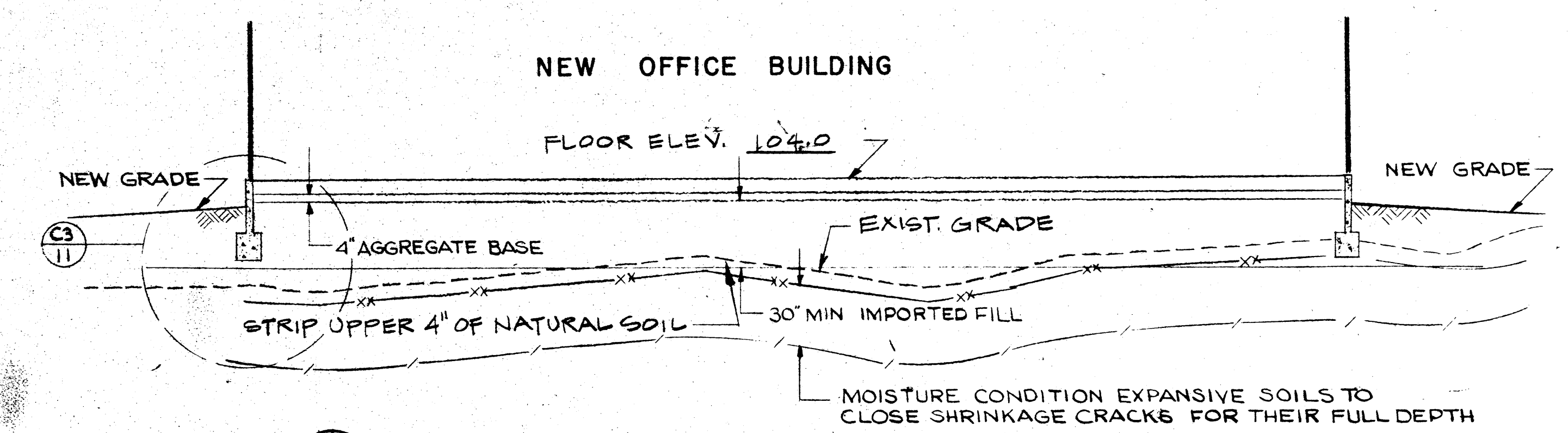

CB 5 TYPICAL BUILDING AREA SECTION
NO SCALE

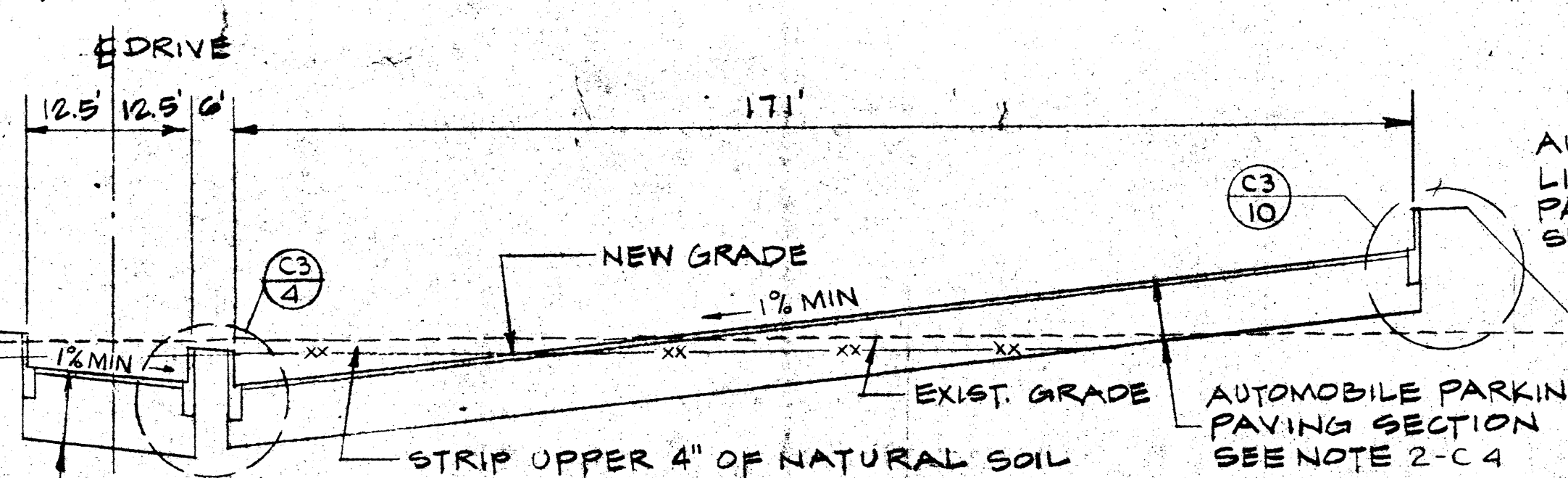

CB 6 TYPICAL DRIVE & PARKING SECTION
NO SCALE

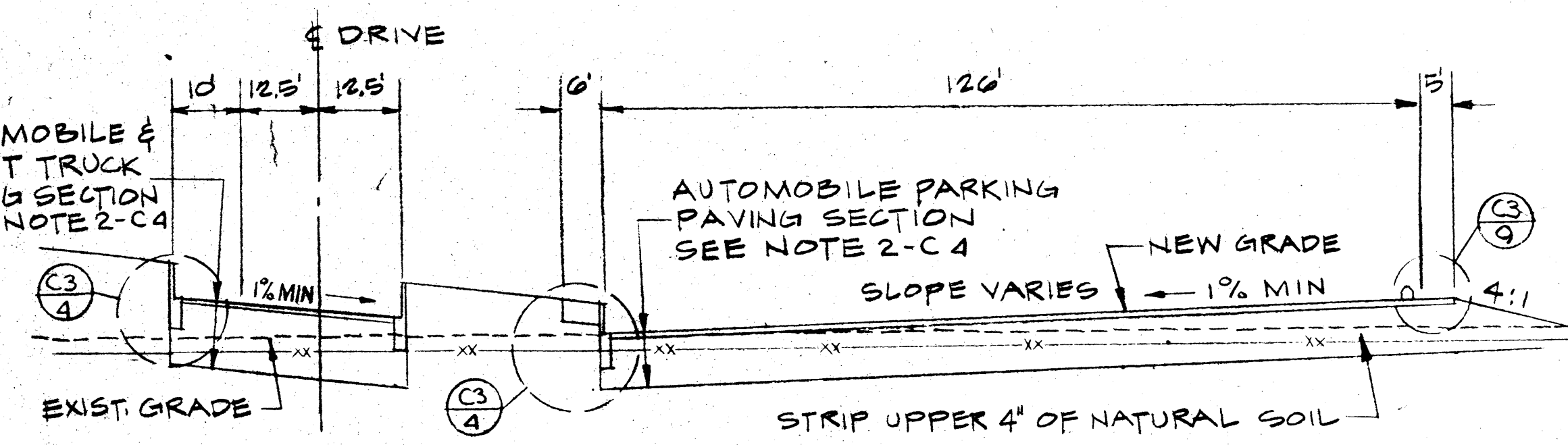

CB 7 TYPICAL DRIVE & PARKING SECTION
NO SCALE

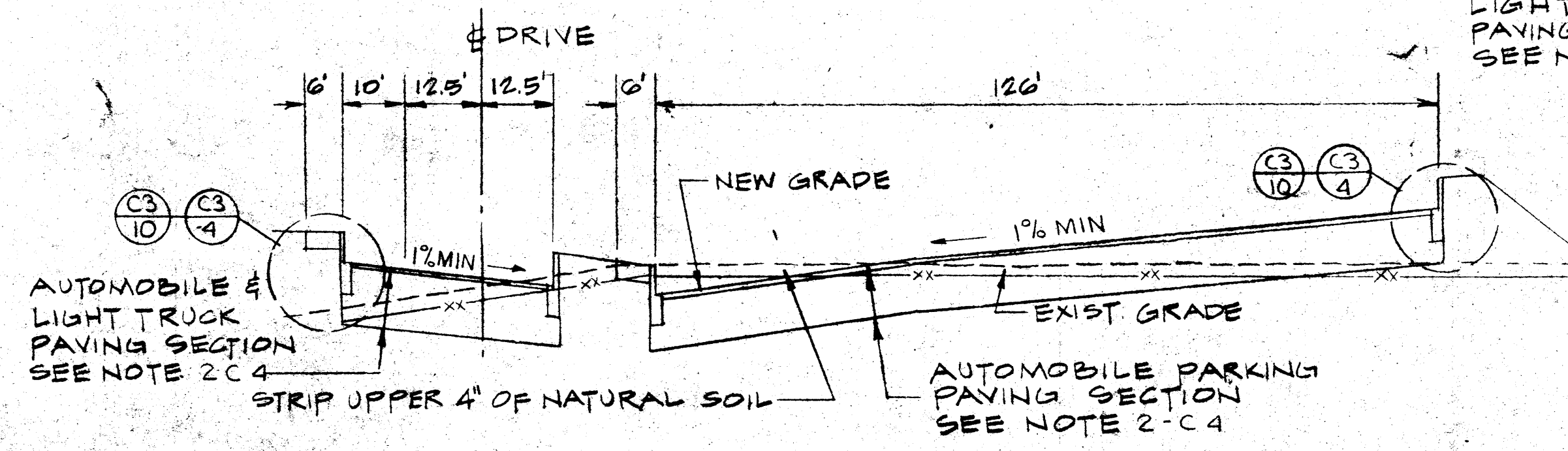

CB 8 TYPICAL DRIVE & PARKING SECTION
NO SCALE

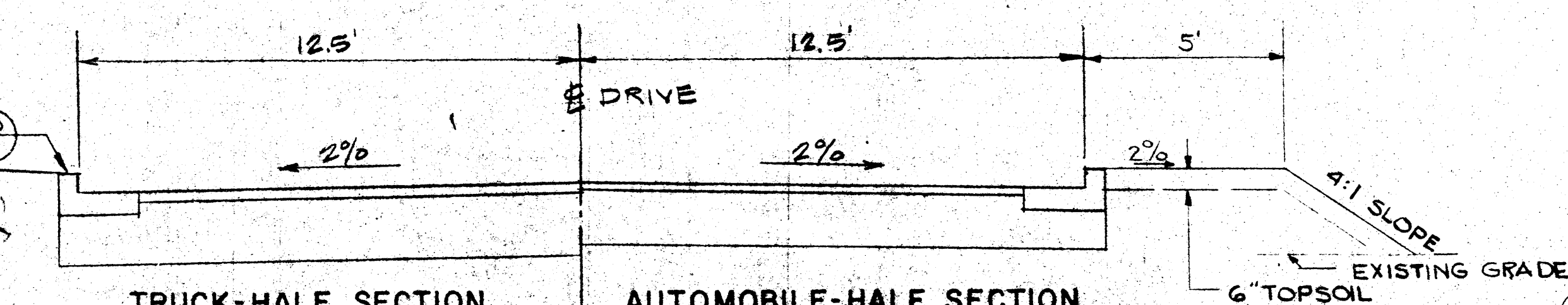

CB 9 TYPICAL DRIVE-HALF SECTIONS
HALF SECTIONS SYMMETRICAL ABOUT CENTER LINE.
SEE NOTE 2 FOR DEPTH OF SECTIONS. SHT. C4
NO SCALE

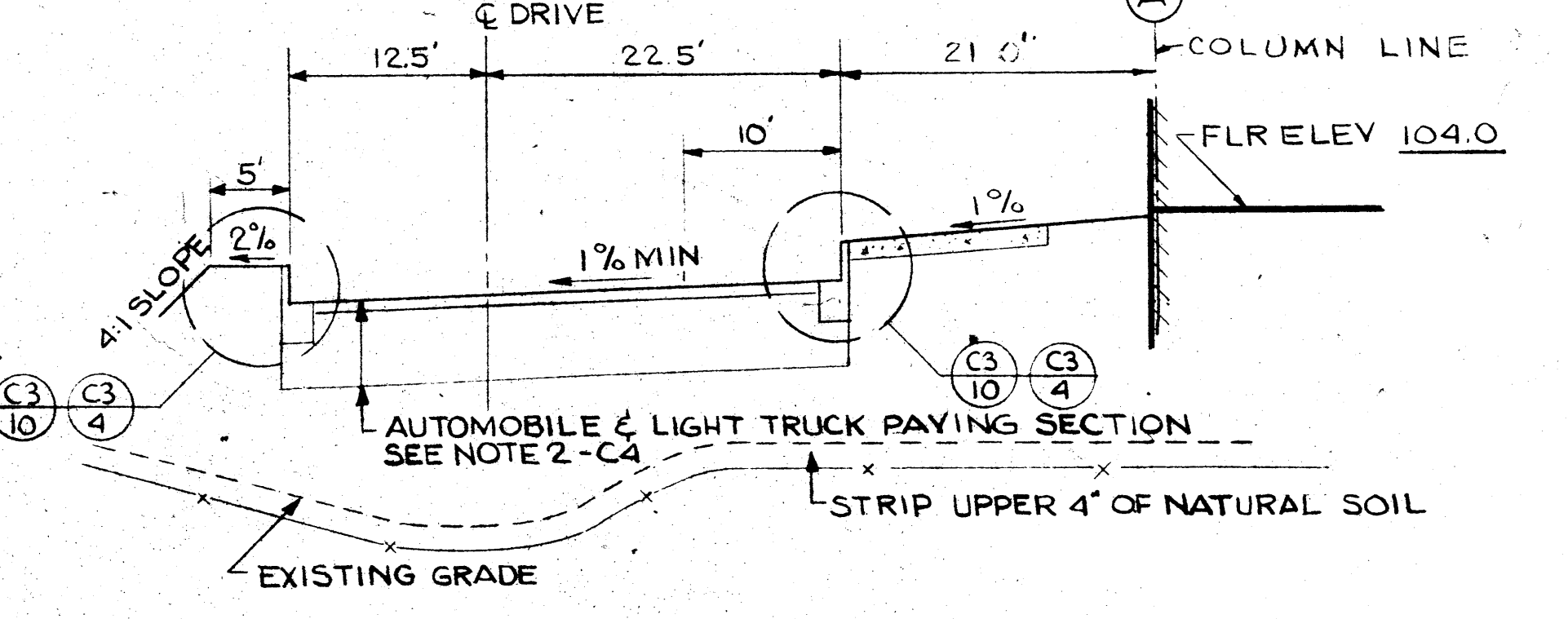

CB 10 TYPICAL DRIVE & DROP-OFF SECTION
NO SCALE

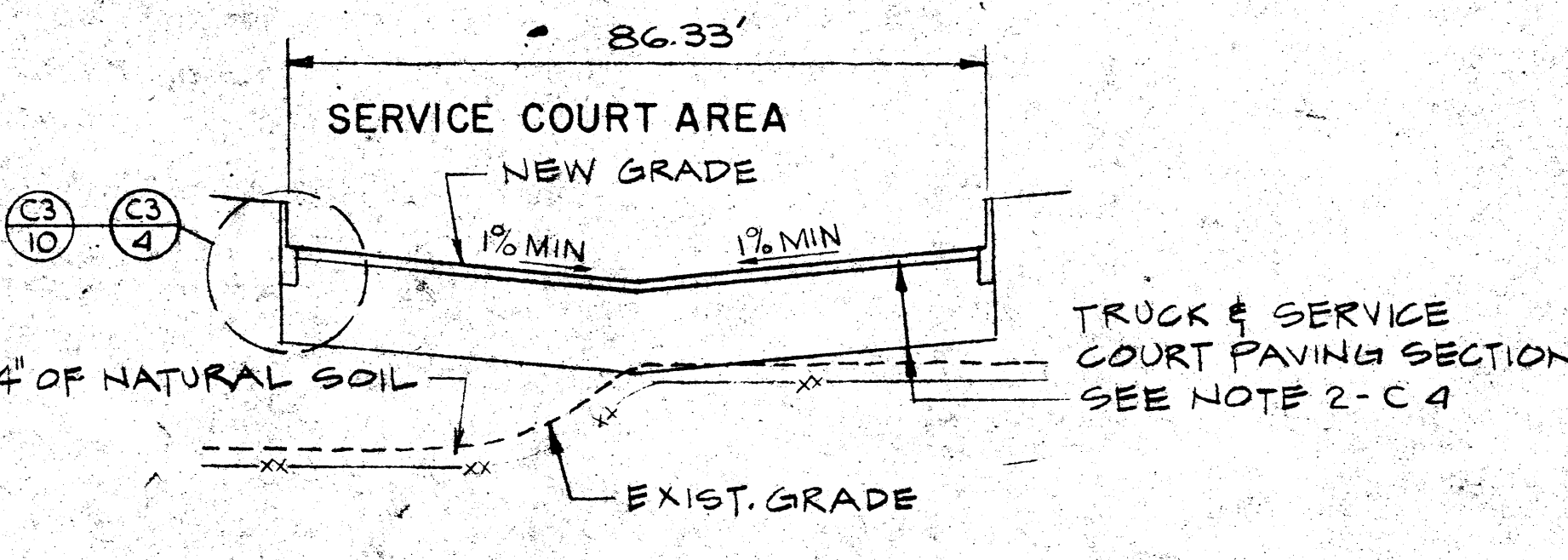

CB 11 SERVICE COURT AREA SECTION
NO SCALE

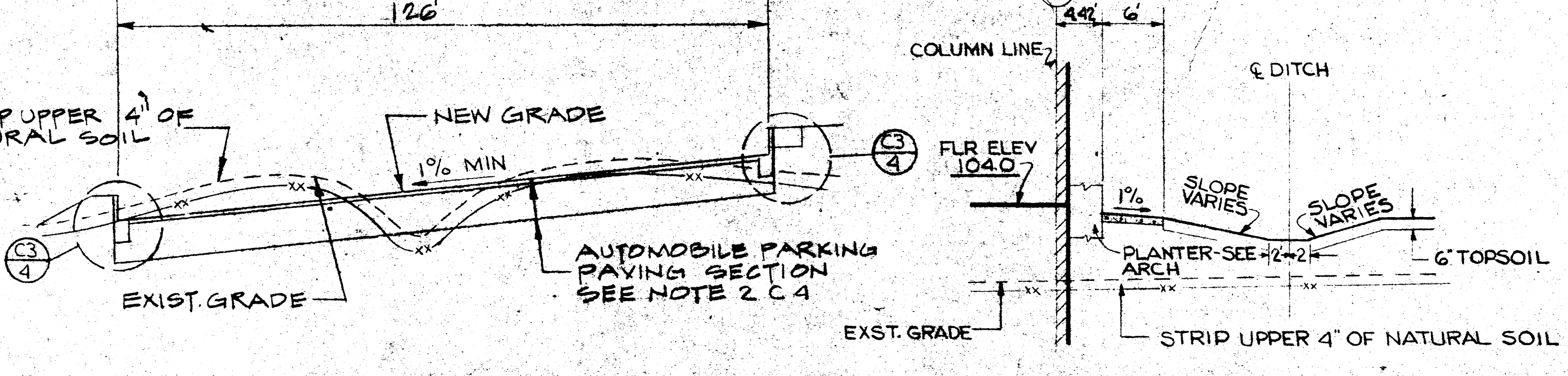

CB 12 TYPICAL PARKING SECTION
NO SCALE

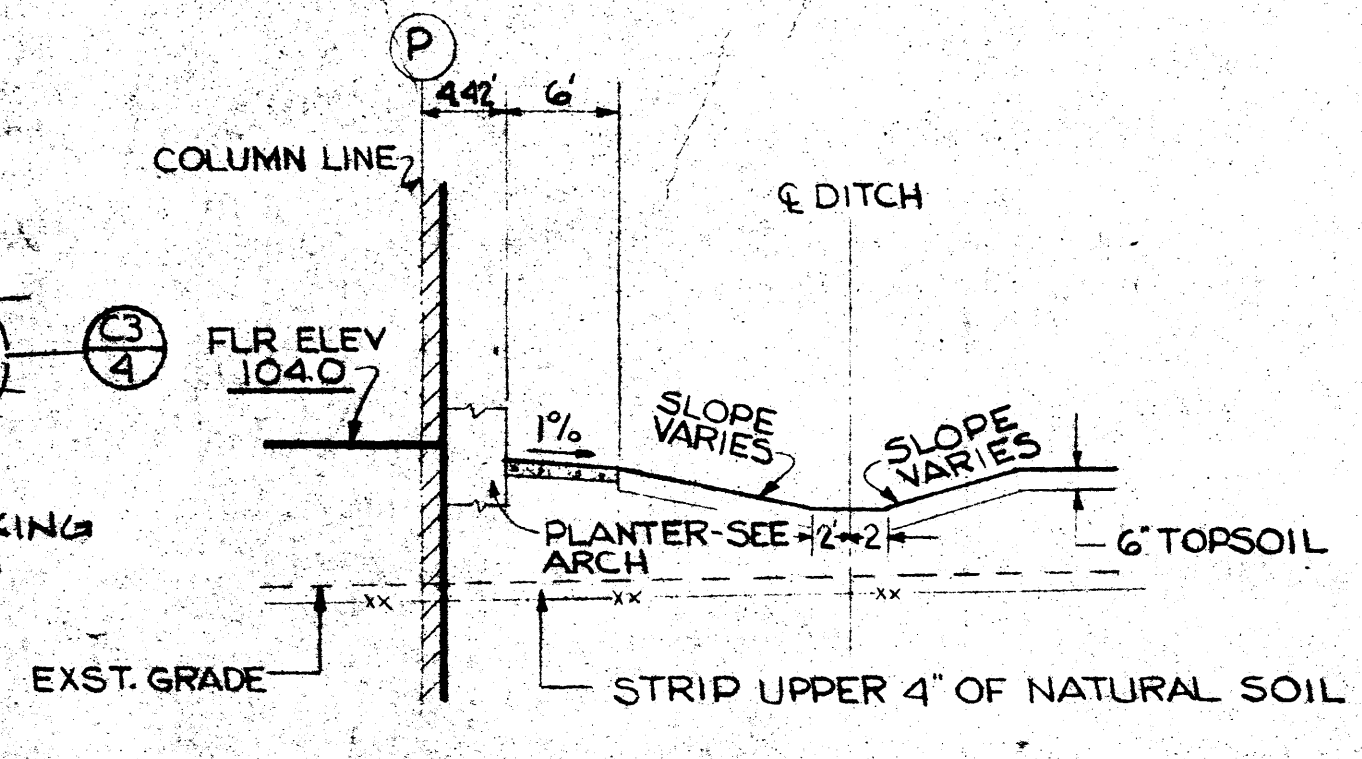

CB 13 DITCH SECTION
NO SCALE

NOTES:
1. IMPORTED SELECT FILL SHALL BE USED UNDER ALL SIDEWALK AND PAVEMENT AREAS.
2. SEE NOTE 2 SHEET C4 FOR PAVEMENT SECTIONS.

REVISION	DATE	NUMBER
	5-20-76	JDB
PROFILES & SECTIONS		
NORTHERN CALIFORNIA REGIONAL OFFICE ROHNERT PARK, CALIFORNIA		
DRAWN BY: RWG		
CHECKED BY: LWE		
COMM. NO. 5521-6220		
SHEET NO.		
C8		
WILLIAM R. SHANNON, JR., A.I.A. REGISTRATION NO. C4493 STATE OF CALIFORNIA		
ONE APPLE TREE SQUARE BLOOMINGTON, MINNESOTA 55420		
Ellerbe		

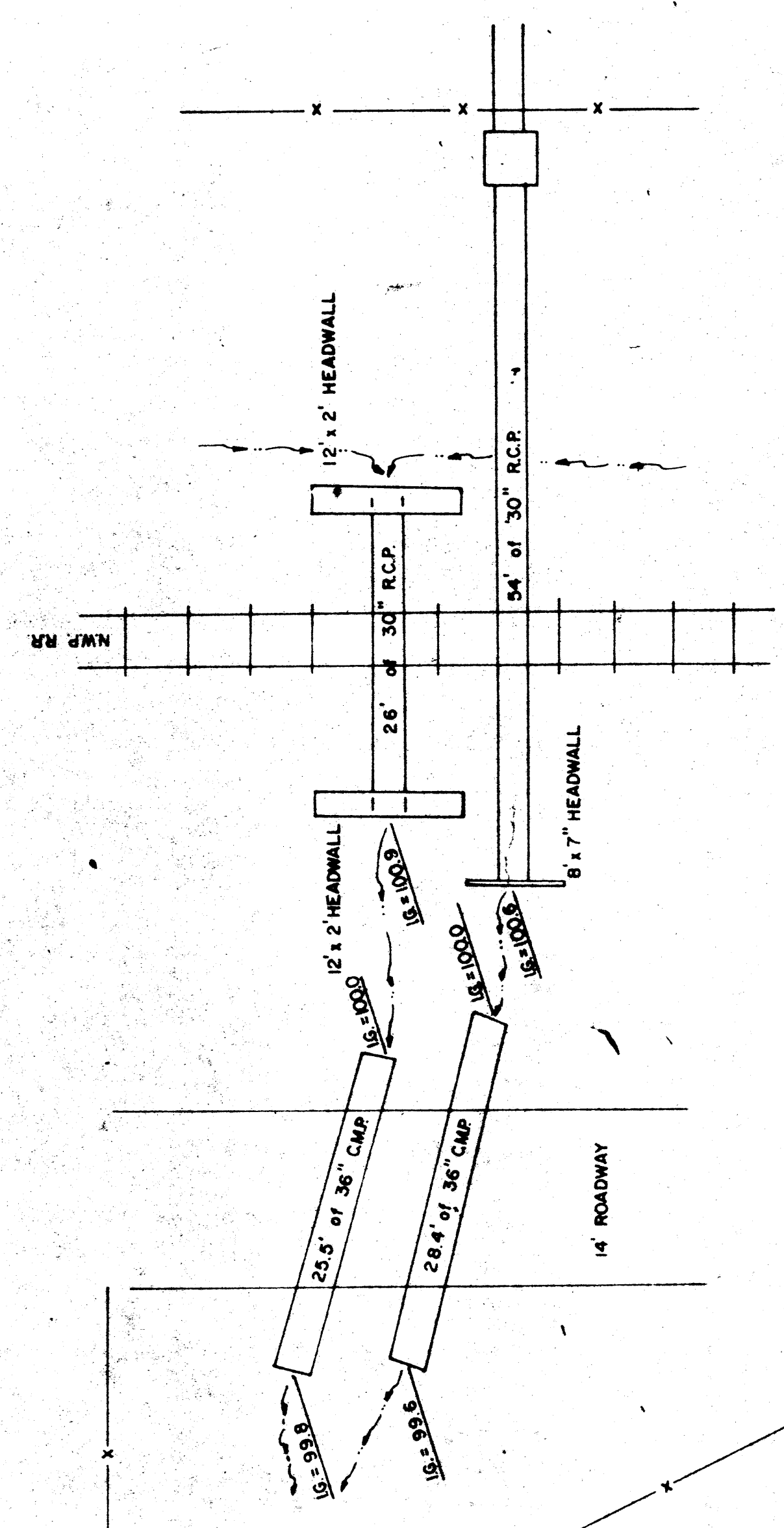
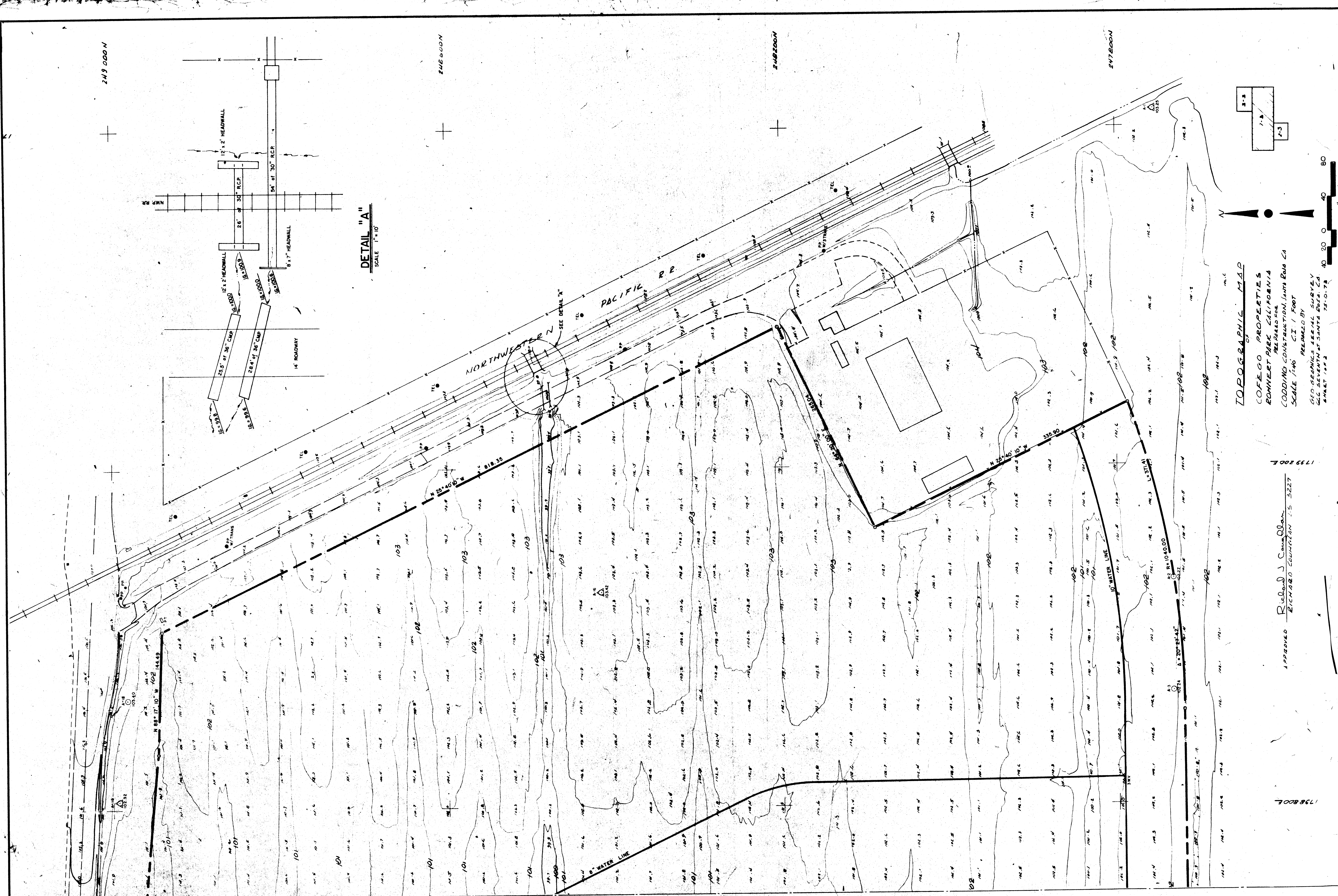

TOPOGRAPHIC MAP
COFFEY PROPERTIES
ROHNERT PARK CALIFORNIA
PREPARED FOR
CODDING CONSTRUCTION, JAMES EARL CO
SCALE 1" = 40' FOOT
PREPARED BY
GEO. GEORGE & ASSOCIATES
222 SEVENTH ST. SANTA ANA, CA
SHEET 1738

APPROVED Richard Shannon
REGISTERED SURVEYOR NO. 3227

MATCH LINE

REVISION	DATE	NUMBER
ORIGINAL SURVEY	5-20-76	
NORTHERN CALIFORNIA REGIONAL OFFICE ROHNERT PARK, CALIFORNIA		
STATE FARM MUTUAL AUTOMOBILE INSURANCE COMPANY BLOOMINGTON, ILLINOIS		
R.O. 39-1	COMM. NO. 5521 622D	SHEET NO.
WILLIAM R. SHANNON, JR., A.I.A. REGISTRATION NO. C4483 STATE OF CALIFORNIA		ONE APPLE TREE SQUARE BLOOMINGTON, MINNESOTA 55408

C10

